

A

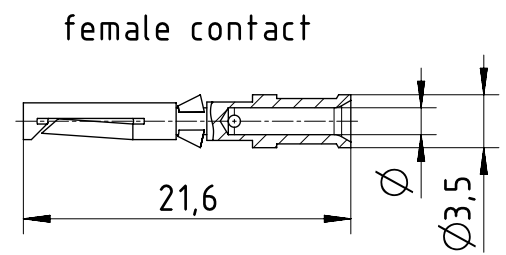
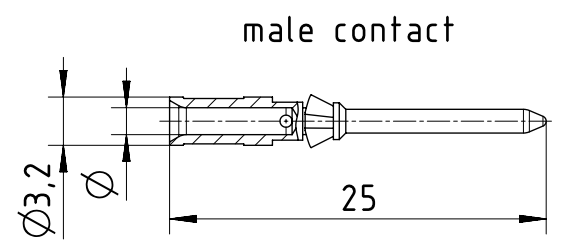

B

C

D

Note: position of the inspection hole is on the crimp collar for 2.5mm² female contacts and the crimp collar of the 2.5mm² male contacts has no shoulders

| Part no. 09 15 000 | | | | Ø | Wire gauge | | Stripping length | Recommended crimping tools | | | | |
|-------------------------|----------------|--------------|----------------|------|-----------------|-------|------------------|----------------------------|----------------|----------------|----------------|--|
| silver plated | | gold plated | | | mm ² | AWG | | 09 99 000 0888 | 09 99 000 0001 | 09 99 000 0110 | 09 99 000 0021 | |
| male contact | female contact | male contact | female contact | | | | | | | | | |
| 6107 | 6207 | 6127 | 6227 | 0,90 | 0,14-0,37 | 26-22 | 8 | X | X | | | |
| 6104 | 6204 | 6124 | 6224 | | | | | | | X | X | |
| 6103 | 6203 | 6123 | 6223 | 1,10 | 0,5 | 20 | | X | X | X | X | |
| 6105 | 6205 | 6125 | 6225 | 1,30 | 0,75 | 18 | | X | X | X | X | |
| 6102 | 6202 | 6122 | 6222 | 1,45 | 1 | 18 | | X | X | X | X | |
| 6101 | 6201 | 6121 | 6221 | 1,75 | 1,5 | 16 | | X | X | X | X | |
| 6106 | 6206 | 6126 | 6226 | 2,25 | 2,5 | 14 | | 6 | X | X | | |

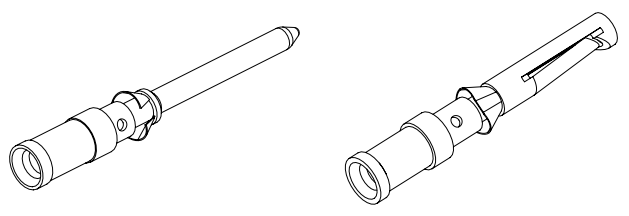

| | | | | | | |
|-------------------------------------|--|----------------------|---|-----------------|--|------------------------|
| | All Dimensions in mm Original Size DIN A4 | Scale 2:1 | Free size tol. | | Ref. | |
| | All rights reserved Department EL PD | Created by 100887 | Inspected by SUNDERMEIER | Standardisation | Date 2021-08-30 | State Final Release |
| Title Han D contacts male/female | | | | | Doc-Key / ECM-Nr. 100109246/UGD/004/F 500000201808 | |
| HARTING D-32339 Espelkamp | | Type TB | Number 09150006101 09150006102 09150006103 09150006104 | | | Rev. |