

TECHNISCHE DATEN:

Aufbau

Dichtring Polychloropren-Nitrilkautschuk CR/NBR

Eigenschaften

- zur Verwendung in PERFECT Kabelverschraubungen

Temperaturbereich -20 °C / +100 °C

Hinweis montiert in den PERFECT Serien:

Pg: 50.0xx, 50.0xx/EMV, 50.0xx PAzzzz,

50.0xx PA/FLzzzz, 50.0xx PABSzzzz

NPT: 50.1xx PAzzzz

metrisch: 500xxMxxPAzzzz, 500xxMxxPABSzzzz

TECHNICAL DATA:

Configuration

Sealing ring Polychloroprene-Nitrile rubber CR/NBR

Properties

- for use in PERFECT cable glands

Temperature range -20 °C / +100 °C

Comment assembled in PERFECT series:

Pg: 50.0xx, 50.0xx/EMV, 50.0xx PAzzzz,

50.0xx PA/FLzzzz, 50.0xx PABSzzzz

NPT: 50.1xx PAzzzz

metric: 500xxMxxPAzzzz, 500xxMxxPABSzzzz

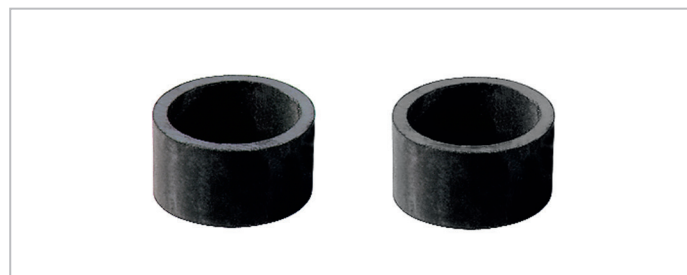
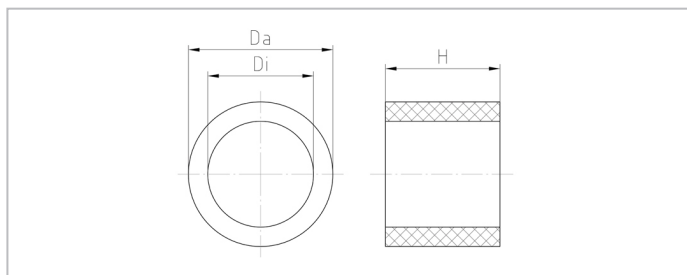

Merkmale

Characteristics

Größe / Size	H	Da	Di		Art.-Nr. / Part No.
xx	mm	mm	mm		
07/12	6,5	8,5	6,8	100	WJ-D 7
09	7,5	10,6	8,3	100	WJ-D 9
11/16	8,5	13,3	10,3	100	WJ-D 11
13/20	8,5	15,3	12,3	100	WJ-D 13
16/20	09	17,3	14,3	50	WJ-D 16
21/25	11	22,3	18,3	50	WJ-D 21
29/32	14	30,3	25,3	25	WJ-D 29
36/40	17,5	40,3	34,3	10	WJ-D 36
42/50	19	45,3	38,3	5	WJ-D 42
48/63	16,5	51	44	5	WJ-D 48